

— SUMMER 2025 —

Transfer Student & Family Orientation



New Paltz
STATE UNIVERSITY OF NEW YORK

Table of Contents

Welcome	1
Getting Acquainted with Campus	2-5
Student Schedule	6
Family Schedule	7
Student Experience Breakout Sessions	8
Important Dates	9
Campus Contacts	9
Best Week Ever: Welcome Week	10
SUNY New Paltz Alma Mater	11
Orientation Experience	12
Campus Maps	Back Covers

If you need assistance, please contact Orientation at the Center for Student Engagement during our business hours, Monday through Friday, 8:00 a.m. – 4:00 p.m. at 845-257-3088.

If there is an after-hours emergency, please contact the SUNY New Paltz University Police Department at 845-257-2222.



Welcome New Students!

The Orientation Team is excited to welcome you to the **Hawks** family where we value creativity, inclusion, and exploration! As your Orientation Leaders (OLs), we are thrilled that you have decided to spread your wings and soar into an incredible journey here at SUNY New Paltz!

The next few years will be filled with memorable experiences, challenges, and opportunities for personal and academic growth. Know that we have been in your shoes – new to campus, full of questions, and feeling different emotions. We are here to help with making your transition as smooth and exciting as possible.

We understand that stepping into a new community can be overwhelming at first, but SUNY New Paltz is a place where you will find your home away from home. Each of us has discovered our path here and we are here to show that you are capable of doing the same.

Orientation is just the beginning of your New Paltz journey, so make the most of it by connecting with fellow students and staff, exploring the resources available to you, and joining student organizations! Our advice? Ask as many questions as you can, introduce yourself to other incoming students, and start imagining what you want to accomplish during your time as a **Hawk**.

Welcome to the nest! We are anticipating how you will make your mark here so make this journey of yours unforgettable!

Go Hawks!

Your Orientation Leader Team

Stay Connected!

Follow us on social media to stay up to date with the happenings on campus!

@NPOrientation
@NewPaltzCSE



My Orientation Leader's Social Media Handle:

Get Acquainted with Campus

Student Union Building

Basement

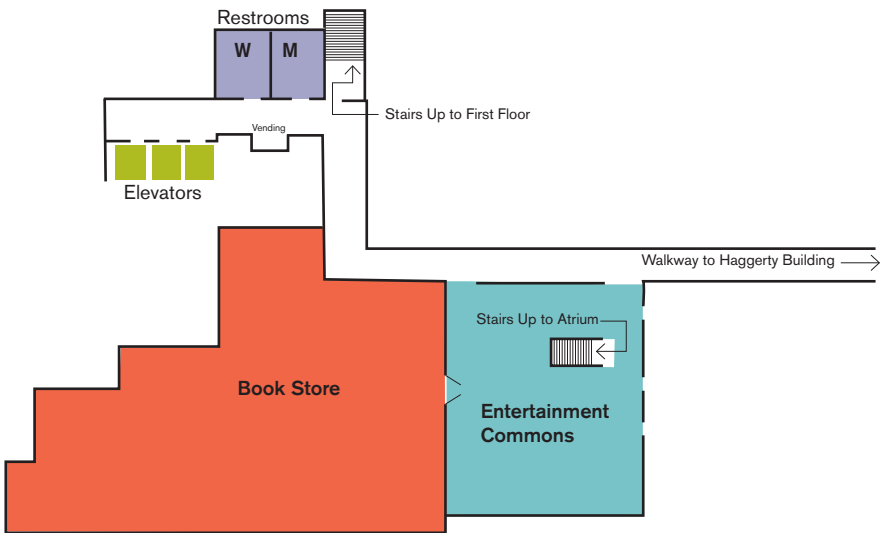

Student Union Building

First Floor

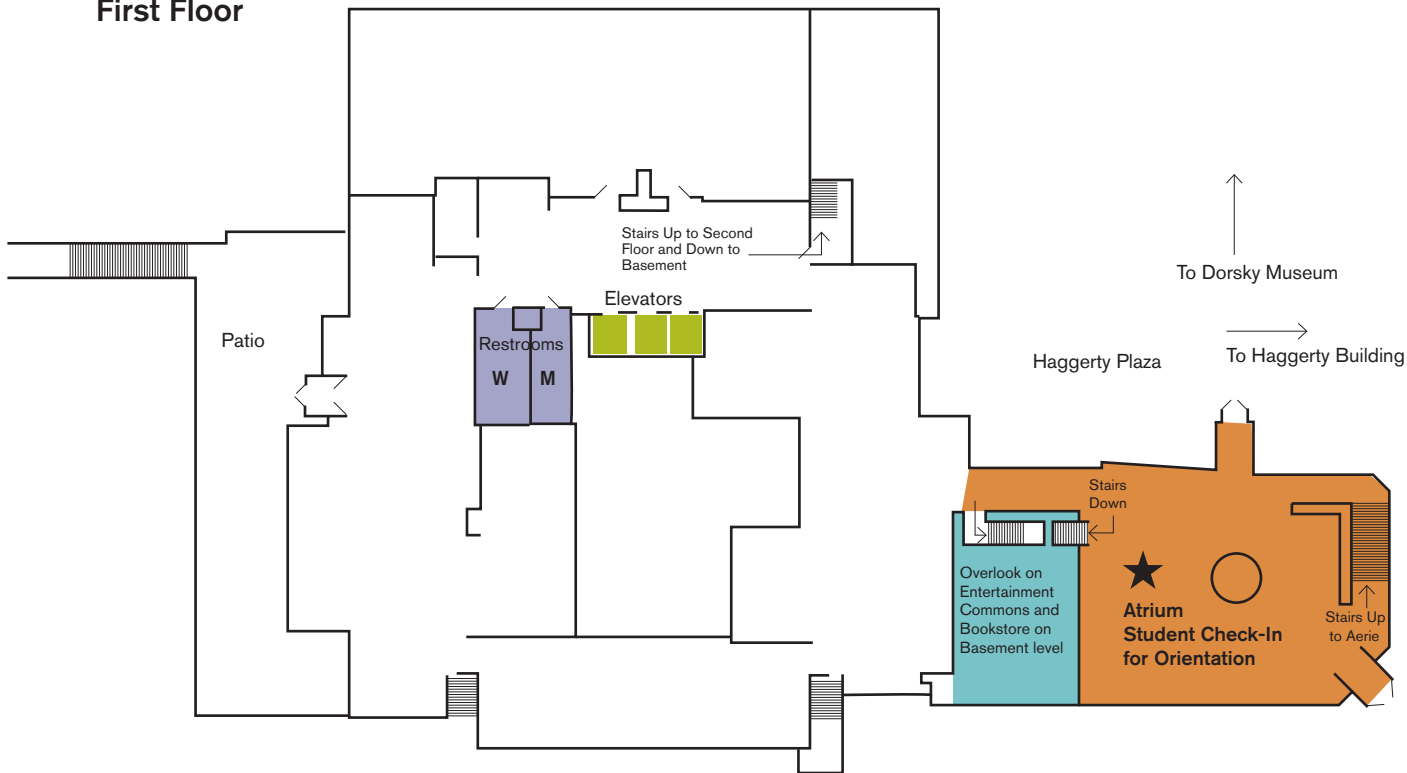

Student Union Building

Second Floor

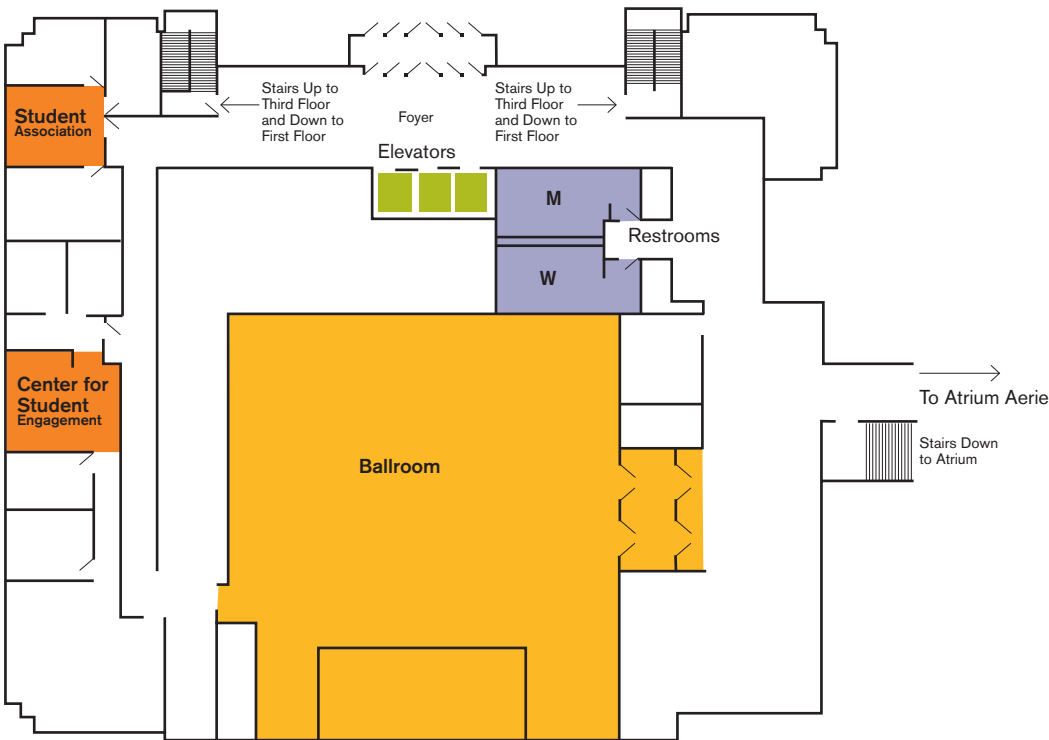

Student Union Building

Third Floor

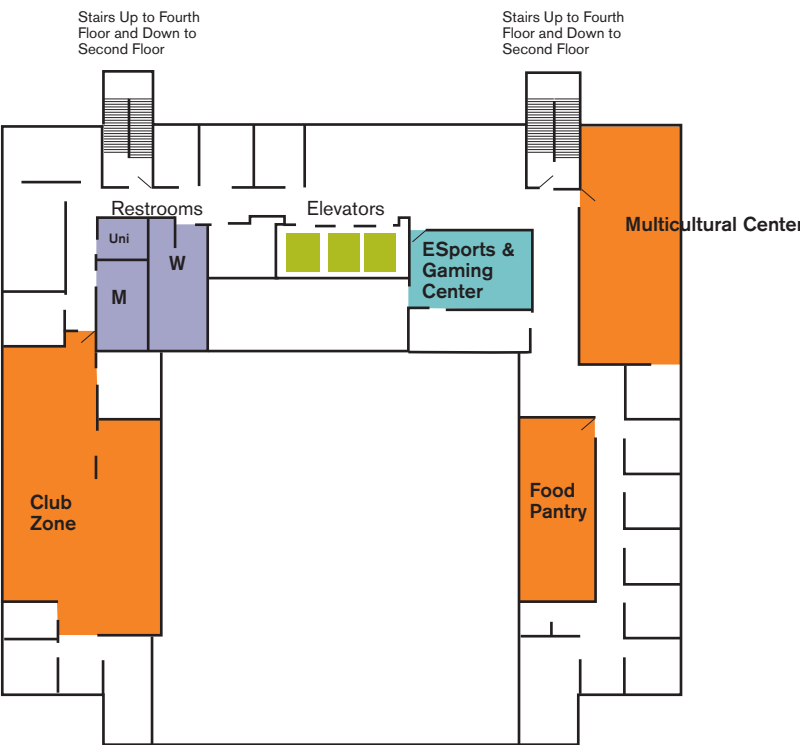

Get Acquainted with Campus

Student Union Building

Fourth Floor

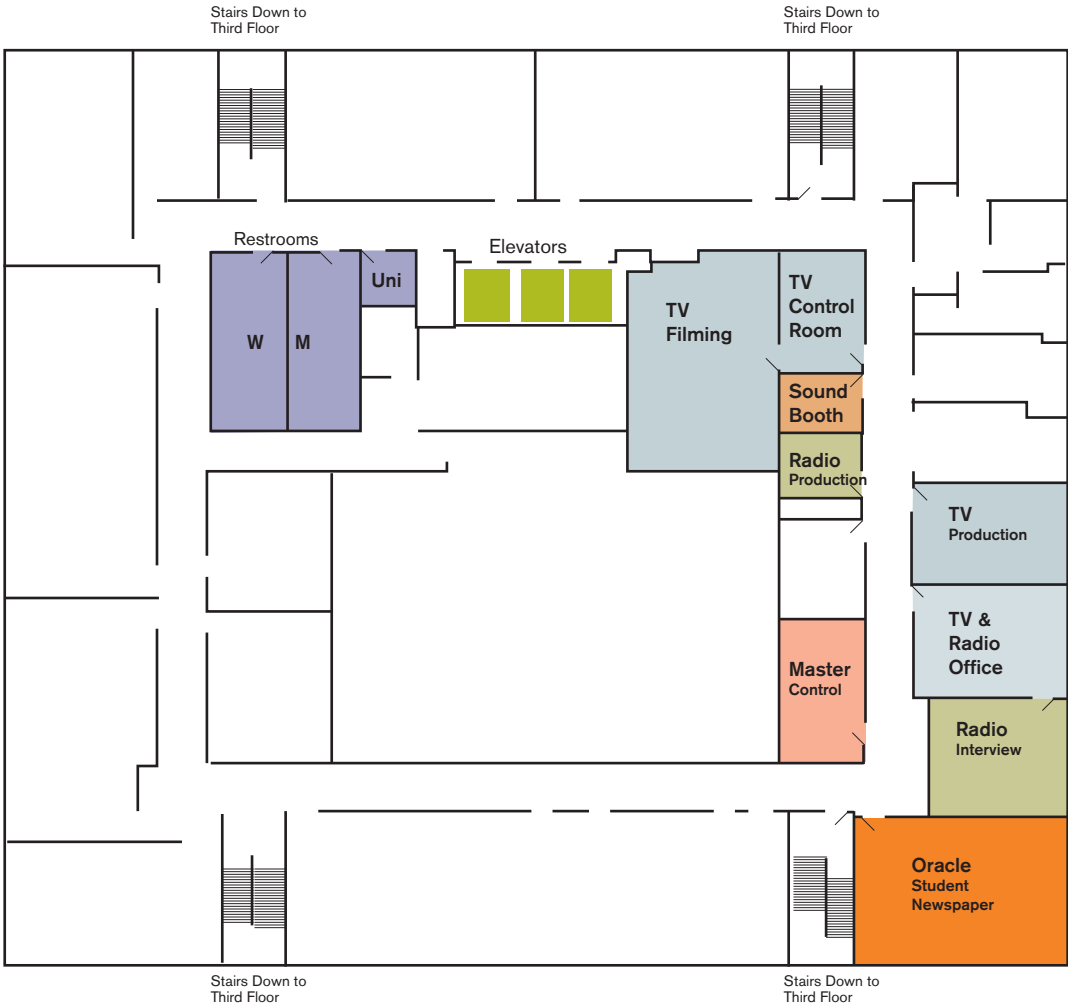

Lecture Center

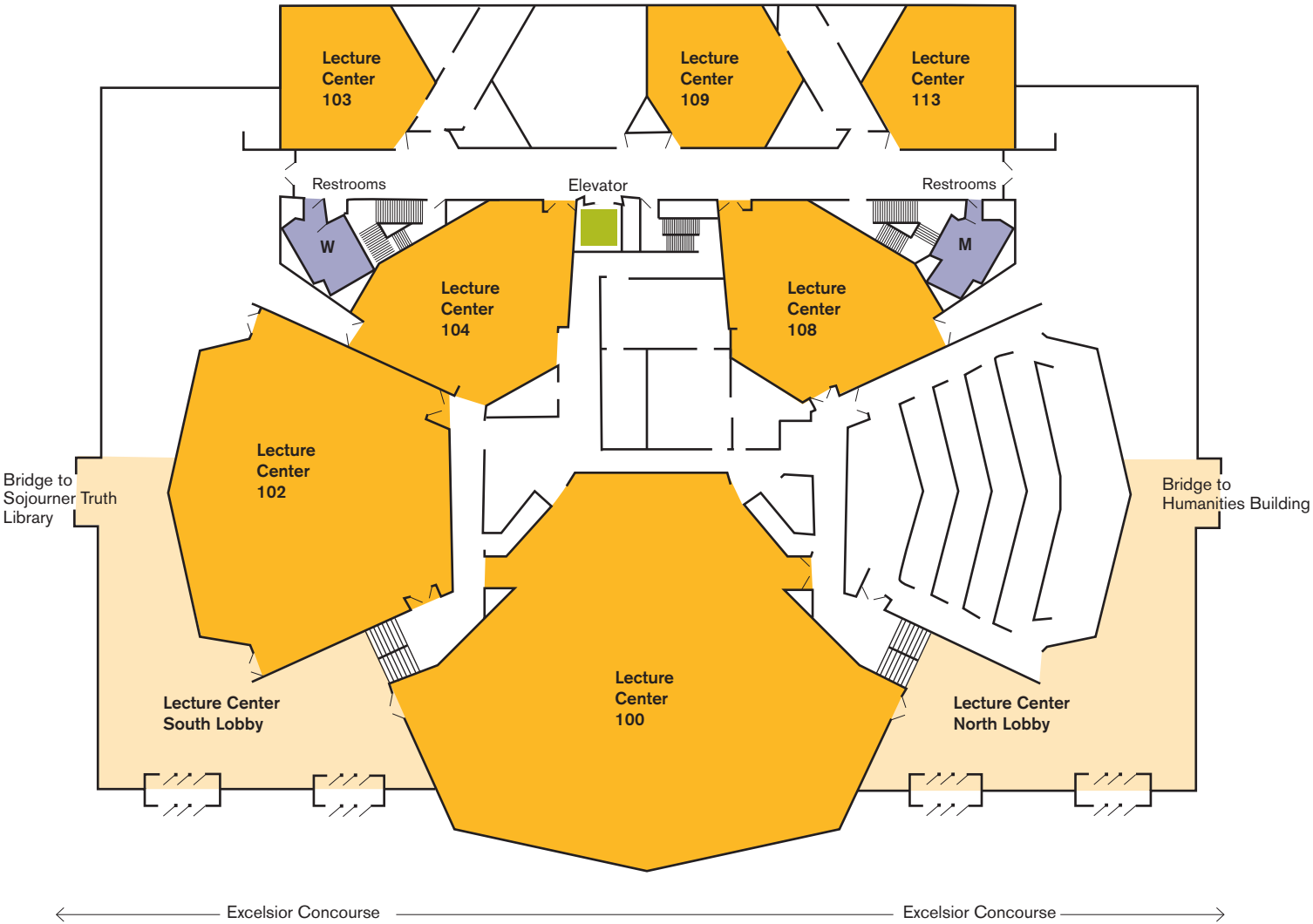

Transfer Student Schedule

 For both students and families



8:00 a.m. to
9:00 a.m.

Check-In & Campus Resource Fair – Lecture Center
Check-in with the Orientation and Center for Student Engagement staff to receive information and materials for this one-day experience! After checking in, feel free to grab breakfast and explore the Campus Resource Fair where you will meet campus partners excited to tell you about themselves and involvement opportunities!



8:30 a.m. to
9:00 a.m.

Building Your Nest
Residential Students: Lecture Center 104
Commuter Students: Lecture Center 102
Whether you're living on campus or commuting, this session will help you make the most of your SUNY New Paltz experience! Residential students will also complete their housing survey and start shaping their home away from home.



9:10 a.m. to
9:45 a.m.

Welcome to SUNY New Paltz – Lecture Center 100
This is your official welcome to SUNY New Paltz and kickoff to your Orientation experience! You will be greeted by President Wheeler, officially meet the Orientation Team, and learn more about today's schedule!



9:45 a.m. to
10:100 a.m. and
10:15 a.m. –
10:35 a.m.

Student Experience Breakout Sessions – Various Locations
Students and their families can explore key campus resources and discover how they contribute to a rewarding SUNY New Paltz experience. During two designated time blocks, you'll have the flexibility to select sessions that interest you most. [Details and locations for each session are listed on page ?](#).

10:35 a.m. to
10:40 a.m.

Recharge
Before beginning the next session, this is the opportunity to use the restrooms and grab a snack.

10:45 a.m. to
11:15 a.m.

Together We Soar – Lecture Center 102
This session lays the foundation for embracing diversity, equity, and inclusion at SUNY New Paltz by fostering an appreciation for the many backgrounds, cultures, and perspectives that create a sense of belonging on campus. Students will leave with the confidence to navigate college life with understand- ing, respect, and a commitment to inclusivity.



11:20 a.m. to
11:50 a.m.

Choices & Community – Lecture Center 100
This session features the Office of Student Conduct & Community Standards and the Title IX team, along with an overview of key wellbeing initiatives offered on campus. Learn how SUNY New Paltz supports a safe, respectful, and healthy community through policies, resources, and programs available to all students.

11:55 a.m. to
12:25 p.m.

Lunch – Lecture Center
Before meeting with the Academic Advisement team, enjoy lunch with the other Transfer students and the Orientation team!!

12:30 p.m. to
4:00 p.m.

Course Registration
Students will meet the Transfer Liaisons in Lecture Center 100 before heading to the respective loca- tions for course registration.

1:30 p.m. to
4:30 p.m.

Check-Out
After meeting with their Academic Advisor, students will be able to check-out! To receive the exclusive Orientation t-shirt, students must complete the Transfer Orientation Survey.

Transfer Family Schedule

 For both students and families



8:00 a.m. to
9:00 a.m.

Check-In & Campus Resource Fair – Lecture Center
Check-in with the Orientation and Center for Student Engagement staff to receive information and materials for this one-day experience! After checking in, feel free to grab breakfast and explore the Campus Resource Fair where you will meet campus partners excited to tell you about themselves and involvement opportunities!



8:30 a.m. to
9:00 a.m.

Building Your Nest
Residential Students: Lecture Center 104
Commuter Students: Lecture Center 102
Whether you're living on campus or commuting, this session will help you make the most of your SUNY New Paltz experience! Residential students will also complete their housing survey and start shaping their home away from home.



9:10 a.m. to
9:45 a.m.

Welcome to SUNY New Paltz – Lecture Center 100
This is your official welcome to SUNY New Paltz and kickoff to your Orientation experience! You will be greeted by President Wheeler, officially meet the Orientation Team, and learn more about today's schedule!



9:50 a.m. to
10:10 a.m. and
10:15 a.m. to
10:35 a.m.

Student Experience Breakout Sessions – Various Locations
Students and their families can explore key campus resources and discover how they contribute to a rewarding SUNY New Paltz experience. During two designated time blocks, you'll have the flexibility to select sessions that interest you most. [Details and locations for each session are listed on page \(#\)](#).

10:35 a.m. to
10:40 a.m.

Recharge
Before beginning the next session, this is the opportunity to use the restrooms and grab a snack.

10:45 a.m. to
11:15 a.m.

Merging into SUNY New Paltz – Lecture Center 104
The Psychological Counseling Center will discuss the opportunities and challenges your student may face during their first year at SUNY New Paltz. They will give you ways in which you can support their transition. You will also learn about services offered by the PCC and other campus resources, including how to access and refer students to these support systems



11:20 a.m. to
11:50 a.m.

Choices & Community – Lecture Center 100
This session features the Office of Student Conduct & Community Standards and the Title IX team, along with an overview of key wellbeing initiatives offered on campus. Learn how SUNY New Paltz supports a safe, respectful, and healthy community through policies, resources, and programs avail- able to all students.

11:55 a.m. to
12:25 p.m.

Lunch – Coykendall Science Building
Enjoy lunch with the administrators from across campus as well as the Orientation team! Connect with other families and guests too!

12:30 p.m. to
1:30 p.m.

Student Account 101 - Coykendall Science Building Auditorium
This informative session will cover key topics such as billing and how to navigate student account information. Families and guests will also receive helpful guidance on reviewing invoices, making payments, and accessing available support.

1:55 p.m. to
4:30 p.m.

Staying Safe at SUNY New Paltz - Coykendall Science Building Auditorium
Get to know the SUNY New Paltz University Police Department and learn essential safety tips and resources to stay secure on campus. Meet our dedicated officers, discover campus safety initiatives, and connect with UPD's favorite furry friend during this informative session.

Check-Out
Families and guests do not have to check out with the Orientation team. Please communicate with your student so you know where to meet them when they are done meeting with the Academic Advisor.

Breakout Sessions

Select a session that aligns with your interests and what you feel will best support your transition into the semester. Students and their guests (if applicable) are encouraged to attend different sessions to maximize the information they receive.

**Career Resource Center
Lecture Center 108**
The Career Resource Center will provide a brief overview of the services that it offers to students. Following that, students will participate in an interactive game to learn about the different majors at SUNY New Paltz, how those connect to different career paths, and what they can do during their first year to get ahead of the career development curve!



**Center for Student Success
Lecture Center 109**
This session highlights the wide range of academic support programs available on campus. Discover the resources designed to promote student success, from tutoring and mentoring to study strategies and skill-building opportunities.

**Get Involved on Campus!
Lecture Center 100**
The Center for Student Engagement will provide students with countless opportunities to get involved, build leadership skills, and make lasting connections. Whether through student organizations, fraternity and sorority life, community service, leadership programs, or campus events, getting involved enhances the college experience and helps students find their passion while making a difference on campus.



**Living On Campus Meet-Up
Lecture Center 103**
An opportunity to connect with fellow students who will be living on campus. This session encourages building community, sharing expectations, and starting the semester with familiar faces.















**My Life at New Paltz: Student Panel
Lecture Center 104**
Current New Paltz transfer students share their experiences and insights about transitioning to campus life. An open conversation designed to highlight real stories, challenges, and successes from the transfer student journey. Questions are welcome.

**Non-Traditional Student Meet-Up
Lecture Center 113**
Students who identify as non-traditional are invited to stop by and connect with future classmates. This informal gathering creates space to build community and share experiences before the semester begins.

**Student Affairs Panel (For Guests and Families)
Lecture Center 102**
This session offers insight into the upcoming transition to college life at SUNY New Paltz and highlights the resources in place to support both students and their families throughout the journey.



Important Fall Semester Dates

 21	Move-In August 21	 4-5	Family Weekend: October 4–5	 26-28	Thanksgiving Break November 26–28	 11	Common Exam Day December 11
 21	Best Week Ever- Welcome Week: August 21–27	 13-14	Fall Break (No Classes) October 13–14	 8	Last Day of Classes December 8	 12-18	Fall Semester Final Exams December 12–18
 25	First Day of Classes August 25	 18	Make A Difference Day October 18	 8	Late Night Breakfast December 8		
 27	New Student Convocation: August 27	 3	Black Solidarity Day November 3	 9-10	Study Day December 9–10		

Important Campus Contacts

Athletics, Wellness & Recreation: nphawks.com athletics@newpaltz.edu 845-257-3910	New Paltz Student Association newpaltz.edu/studentaffairs/departments/student-association SA-President@newpaltz.edu 845-257-3070	Student Accounts newpaltz.edu/student_accounts stuacct@newpaltz.edu 845-257-3150
Campus Auxiliary Services - ID Cards newpaltzcas.com 845-257-3034	Office of Academic Advising newpaltz.edu/advising advising@newpaltz.edu 845-257-3015	Student Affairs newpaltz.edu/studentaffairs studentaffairs@newpaltz.edu 845-257-3260
Campus Auxiliary Services - Meal Plans newpaltzdining.sodexomyway.com 845-257-3370	Office of Veteran & Military Services newpaltz.edu/veterans ovms@newpaltz.edu 845-257-6867	Student Conduct & Community Standards newpaltz.edu/student-conduct conduct@newpaltz.edu 845-257-3260
Career Resource Center newpaltz.edu/careers careers@newpaltz.edu 845-257-3265	Parking newpaltz.edu/parking parking@newpaltz.edu 845-257-3347	Student Financial Services newpaltz.edu/financialaid fao@newpaltz.edu 845-257-3250
Center for Student Engagement newpaltz.edu/studentengagement cse@newpaltz.edu 845-257-3025	Psychological Counseling Center newpaltz.edu/counseling 845-257-2920	Student Health Services newpaltz.edu/healthcenter healthservice@newpaltz.edu 845-257-3400
Center for Student Success newpaltz.edu/studentsuccess css@newpaltz.edu 845-257-3580	Psychological Counseling Center: HAVEN newpaltz.edu/counseling/oasishaven.html 845-257-4930	Undergraduate Admission newpaltz.edu/admissions/contact.html admissions@newpaltz.edu 845-257-3200
Disability Resource Center www.newpaltz.edu/drc drc@newpaltz.edu 845-257-3020	Psychological Counseling Center: OASIS newpaltz.edu/counseling/oasishaven.html 845-257-4945	University Bookstore bkstr.com/sunynewpaltzstore 1651mgr@follett.com 845-257-3050
Heritage Financial Credit Union heritagefcu.com/branch/suny-campus 845-561-5607	Residence Life newpaltz.edu/reslife reslife@newpaltz.edu 845-257-4444	University Police newpaltz.edu/police upd@newpaltz.edu 845-257-2222
Mail Services newpaltz.edu/ocm/mail.html MailServices@newpaltz.edu 845-257-3122		

Welcome Week Signature Events





 **Welcome BBQ:**
Kick off the semester with good food, music, and new connections at our Welcome BBQ! Reconnect with your Summer Orientation Leaders and meet fellow students who shared the same OL experience.

 **Best Week Ever Kick-Off: ACW Trivia**
Think you know music? Put your knowledge to the test with ACW Trivia, a high-energy, interactive competition where every question connects to an artist, song, or dance. Compete for cash prizes and bragging rights in this fast-paced trivia showdown—just make sure your phone is charged and your music game is strong!

 **Planetarium Mini Shows:**
Experience the bite-sized versions of our popular "Astronomy Nights" show, which occurs throughout the academic year. These 15-minute shows offer a captivating glimpse into the wonders of the universe.

 **Glow Party:**
Reconnect with friends or make new connections at this exciting event hosted by the Residence Hall Student Association. This Glow Party is packed with dance music, glow items, giveaways, and so much more!

 **Humans vs. Zombies:**
Humans vs Zombies is a modified game of team-based tag featuring Nerf blasters. This special Welcome Week mini game session will give new students a chance to have fun while meeting new friends. The club runs games like this weekly once the semester gets going, so come give it a try!

 **Movie Under the Stars:**
Come join the Center for Student Engagement on Old Main Quad - a popular location for campus events - to watch a box off hit movie for free! Bring your blankets and snacks although some refreshments and snacks may be provided.

 **Shopping Trip @ Poughkeepsie Galleria:**
Need to pick up some items you forgot to bring or buy? Just want to explore the closest mall to campus? Take a trip with the Center for Student Engagement to the Poughkeepsie Galleria. Seating is on a first-come, first-served basis. Buses will return to campus at 5:30pm. If you require accessible transportation, please contact cse@newpaltz.edu prior to the event.

 **Summer Sundown:**
Watch the sunset and say goodbye to summer break together with your classmates. Live music, refreshments with games & giveaways. Bring your own blanket!

 **A Night of Comedy:**
Laughter is medicine for the soul! Join the Center for Student Engagement for an evening filled with fun, side aching laughs, and punchlines from an up-and-coming comedian!

 **Involvement Expo:**
Come to this annual celebration that showcases local business and 220+ student clubs/organizations! Connect through fun, interactive activities at each table that will spark your interest and help you find your place on campus.

 **New Student Convocation:**
Convocation celebrates who you are at the moment you became a New Paltz Hawk! The milestone is something we look forward to celebrating with you. To show your New Paltz pride, be sure to wear the color New Paltz t-shirt you received at Orientation.

 **Hugo's Free for All:**
What's better than free stuff? A whole bunch of free stuff! Join the Student Engagement Board and the Center for Student Engagement for a night of free giveaways and prizes!

 **Poster Sale:**
Join the Center for Student Media for the semesterly poster sale! Thousands of designs, posters small and large will be available for purchase in the Student Union Atrium.

SUNY New Paltz Alma Mater

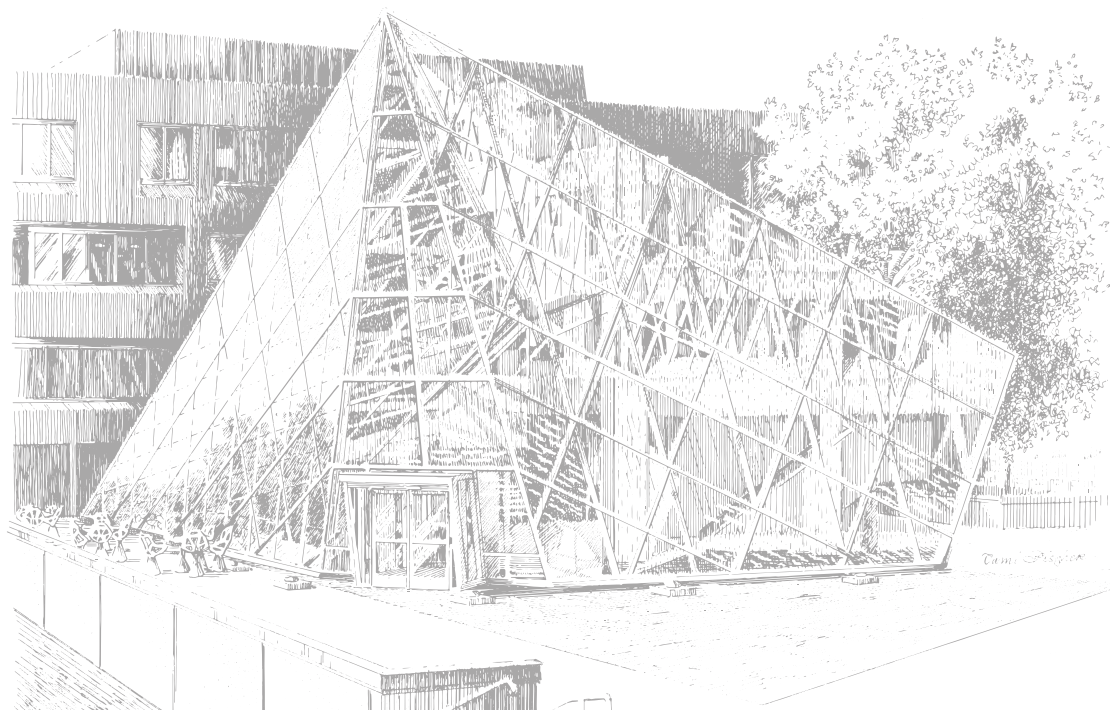

*In a valley fair and beautiful
Guarded well by mount and hill
Beats a heart whose pulse is rich and full
Of life, and pow'r, and thrill.
We love thee, Alma Mater dear.
To thee our hearts are true.
And we'll sing with voices strong and clear
To the Orange and Blue.
New Paltz, forever our Alma Mater,
We raise our song to thee.
The hills re-echo with glad crescendo
Our praises full and free.*

Orientation Experience

How was Your Orientation Experience?
Let us know by completing the Orientation Survey!



Students



Family

Become an Orientation Leader

Summer 2026 Orientation Leader Interest Form
Orientation Leaders (OLs) are a team of dedicated undergraduate students whose primary responsibility is to assist new students and their families with their transition into the SUNY New Paltz community and Hawks family. The Orientation Leader role will provide you with the opportunity to learn more about yourself and your personal values, challenge yourself, and most importantly aid new students in their transition to SUNY New Paltz.

