

— SUMMER 2025 —

First-Year Student & Family Orientation



New Paltz
STATE UNIVERSITY OF NEW YORK

Table of Contents

Welcome	1
Getting Acquainted with Campus	2-5
Student Schedule	6-7
Family Schedule	8-9
Student Experience Breakout Sessions	10
Important Dates	12
Campus Contacts	12
Best Week Ever: Welcome Week	13
Notes	16
Campus Maps	Back Covers

If you need assistance, please contact Orientation at the Center for Student Engagement during our business hours, Monday through Friday, 8:00 a.m. – 4:00 p.m. at 845-257-3088.

If there is an after-hours emergency, please contact the SUNY New Paltz University Police Department at 845-257-2222.



Welcome New Students!

The Orientation Team is excited to welcome you to the **Hawks** family where we value creativity, inclusion, and exploration! As your Orientation Leaders (OLs), we are thrilled that you have decided to spread your wings and soar into an incredible journey here at SUNY New Paltz!

The next few years will be filled with memorable experiences, challenges, and opportunities for personal and academic growth. Know that we have been in your shoes – new to campus, full of questions, and feeling different emotions. We are here to help with making your transition as smooth and exciting as possible.

We understand that stepping into a new community can be overwhelming at first, but SUNY New Paltz is a place where you will find your home away from home. Each of us has discovered our path here and we are here to show that you are capable of doing the same.

Orientation is just the beginning of your New Paltz journey, so make the most of it by connecting with fellow students and staff, exploring the resources available to you, and joining student organizations! Our advice? Ask as many questions as you can, introduce yourself to other incoming students, and start imagining what you want to accomplish during your time as a **Hawk**.

Welcome to the nest! We are anticipating how you will make your mark here so make this journey of yours unforgettable!

Go Hawks!

Your Orientation Leader Team

Stay Connected!

Follow us on social media to stay up to date with the happenings on campus!

@NPOrientation

@NewPaltzCSE



My Orientation Leader's Social Media Handle:

Get Acquainted with Campus

Student Union Building

Basement

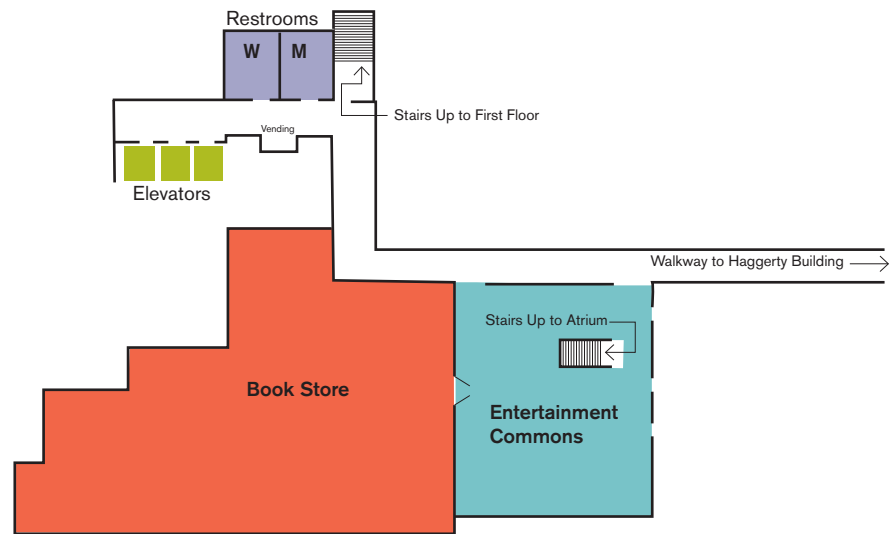

Student Union Building

First Floor

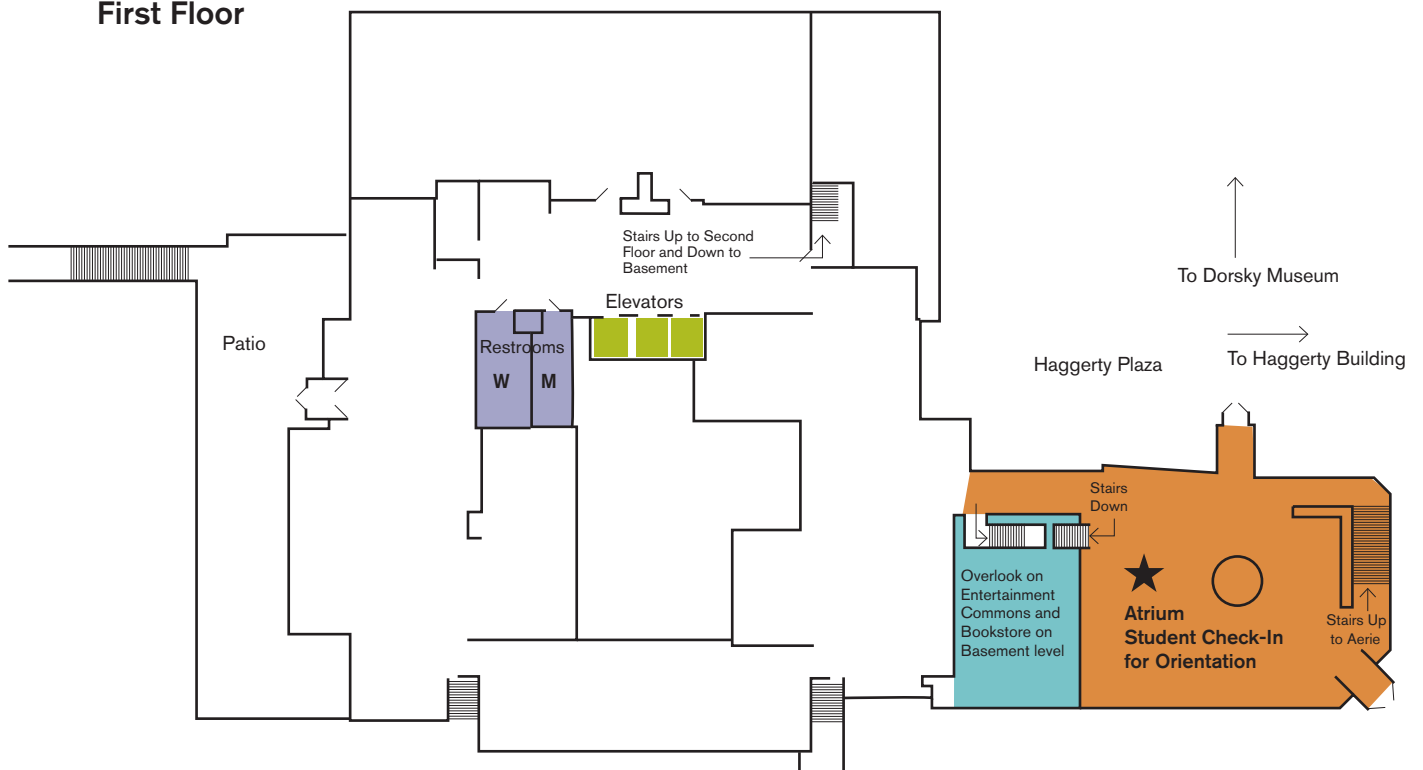

Student Union Building

Second Floor

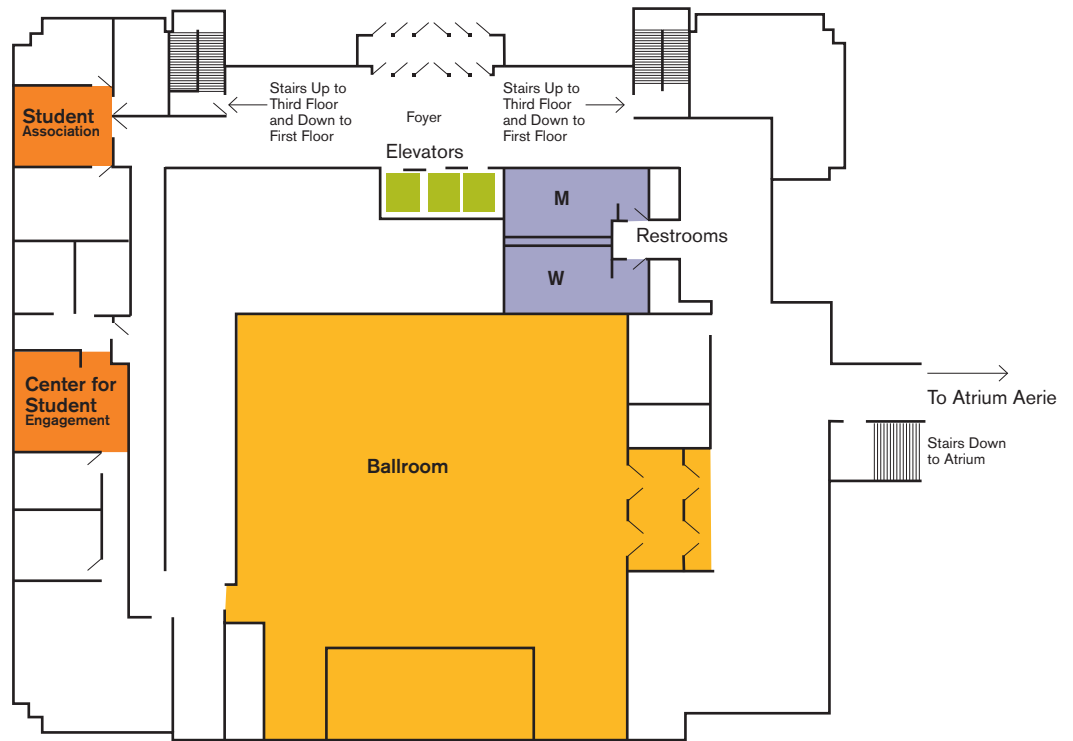

Student Union Building

Third Floor

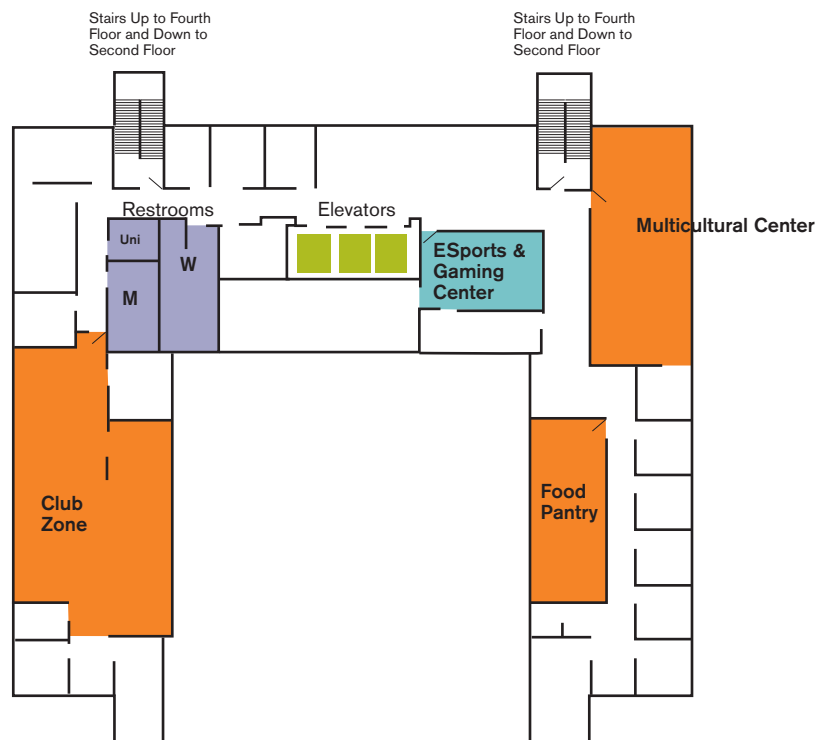

Get Acquainted with Campus

Student Union Building

Fourth Floor

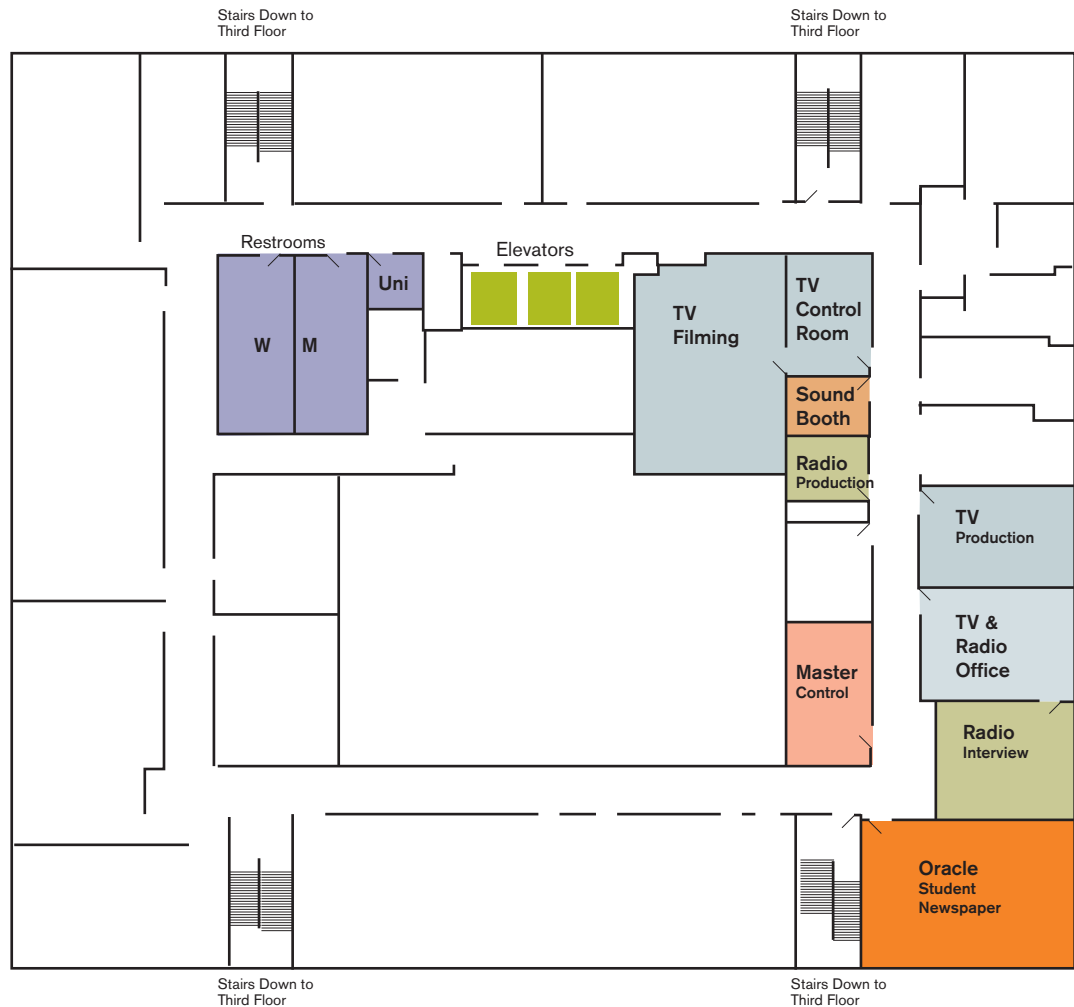

Lecture Center

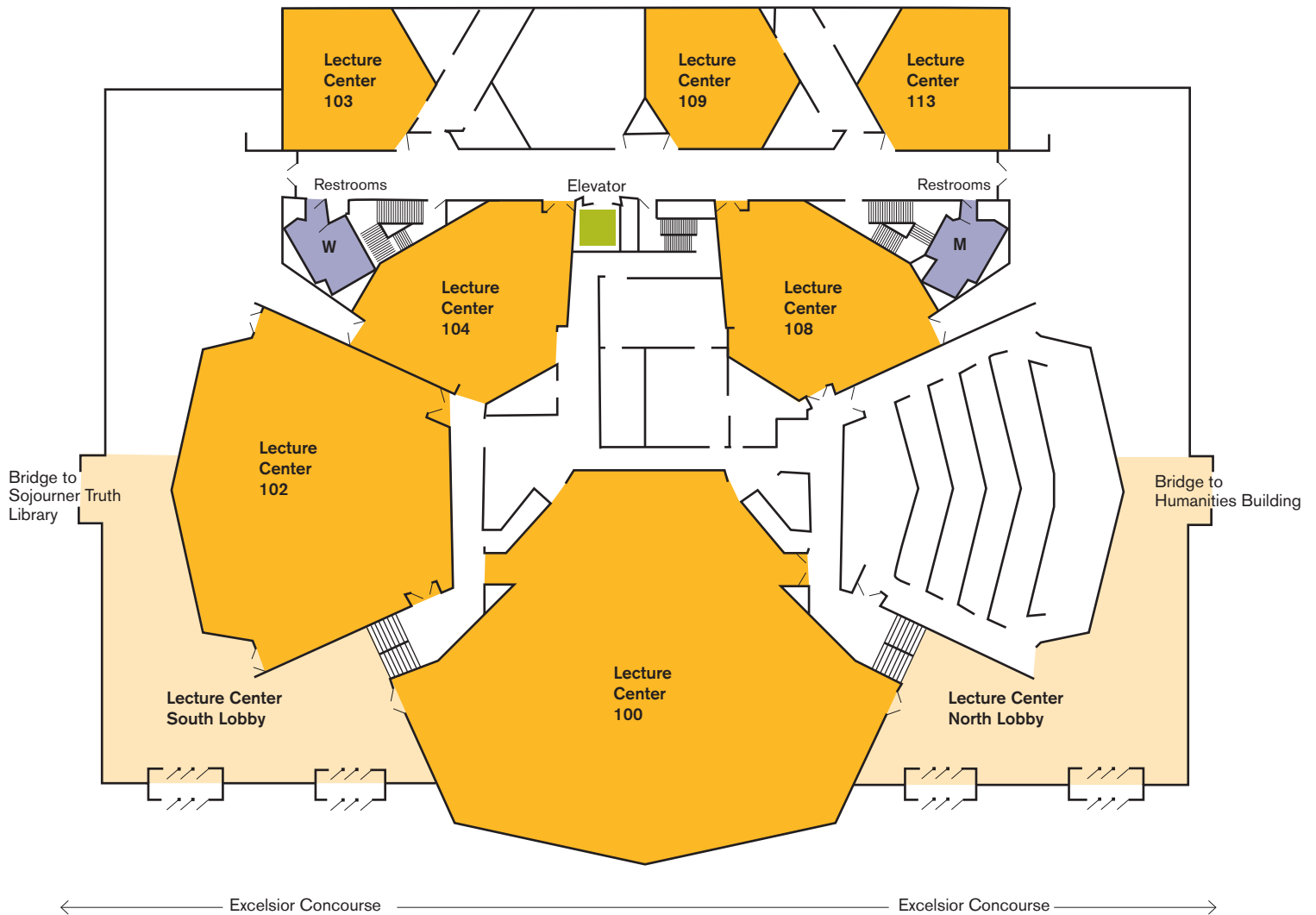

Day One Schedule



For both students and families



8:30 a.m. to 10:00 a.m.

Check-In & Campus Resource Fair

Check in with the Orientation and Center for Student Engagement staff at the Atrium. After checking in, you will be escorted to Bouton Hall, where you will receive your Student ID Card, overnight room assignment, and Orientation Group for this two-day experience! While you wait to check in or after you've moved your belongings into your room, feel free to stop by the Campus Resources Fair, held in the SUB Ballroom, located on the second floor of the Student Union Building. There, you'll meet campus partners excited to share information about themselves and the many involvement opportunities available to you.



10:15 a.m. to 11:00 a.m.

Welcome to SUNY New Paltz – Lecture Center 100

This is your official welcome to SUNY New Paltz and kickoff to your Orientation experience! You will be greeted by President Wheeler and officially meet the Orientation Team, including your Orientation Leader!

11:05 a.m. to 11:35 a.m.

Spreading Your Wings – Lecture Center 100

As a new Hawk, you will experience opportunities, connections, and even challenges as you transition from high school to a college campus. The Psychological Counseling Center will talk to you about healthy transitions, developing resilience, and emotional awareness which will help you soar successfully into SUNY New Paltz.

11:40 a.m. to 12:00 p.m.

Small Group 1 – Various Locations

Meet your Orientation Leader! Pick their brain about what it is like being a current Hawk while getting to know other students in your group. **You can find your Orientational Group Number in the lower right corner of your nametag.**

12:00 p.m. to 1:30 p.m.

Lunch – Peregrine Dining Hall

Enjoy lunch with your small group by swiping your student ID card. Your Orientation Leader will take you to the dining hall at the assigned time.



2:00 p.m. to 2:20 p.m. and 2:30 to 2:50 p.m.

Student Experience Breakout Sessions – Various Locations

Students and their families can explore key campus resources and discover how they contribute to a rewarding SUNY New Paltz experience. During two designated time blocks, you'll have the flexibility to select sessions that interest you most. **Details and locations for each session are listed on page 10.**

3:00 p.m. to 5:00 p.m.

The Orientation Players Presents: Realities – Studley Theatre

Realities is a dynamic, 12-skit production performed by Orientation Leaders that explores key challenges students may face in college. Through engaging and thought-provoking scenes, this session addresses topics like transitioning from high school, social media pitfalls, unhealthy vs healthy relationships, embracing diversity, and more.

5:10 p.m. to 6:30 p.m.

Dinner – Peregrine Dining Hall

Dinner with your small group will become the norm so make sure you have your student ID card. Your Orientation Leader will take you to the dining hall at the assigned time.

6:40 p.m. to 7:40 p.m.

Together We Soar – Lecture Center 100

This session lays the foundation for embracing diversity, equity, and inclusion at SUNY New Paltz by fostering an appreciation for the many backgrounds, cultures, and perspectives that create a sense of belonging on campus. Students will leave with the confidence to navigate college life with understanding, respect, and a commitment to inclusivity.

7:45 p.m. to 8:10 p.m.

Small Group 2 – Various Locations

Your Orientation Leaders will take this time to debrief the day with you, answer any questions you may have, and prepare you for the evening activities.

8:15 p.m. to 9:00 p.m.

Community Connections – Lecture Center, Various Locations

Recharge and connect with other students by participating in different activities that will keep you entertained before calling it a night!

9:05 p.m. to 10:00 p.m.

Late Night Activity – Bouton Hall

This optional session provides another opportunity for students to unwind from the long day in Bouton Hall.

Day Two Schedule



For both students and families

**7:30 a.m. to
8:30 a.m.**

Breakfast – Peregrine Dining Hall

Breakfast with your small group allows you to start the last day of Orientation making lasting memories. Your Orientation Leader will take you to the dining hall at the assigned time.

**8:30 a.m. to
11:15 a.m.**

Academic Overview & Registration - Refer to Email

Students will register for their fall 2025 semester courses - their first official schedule at SUNY New Paltz! With the assistance of professional advisors from the Office of Academic Advising and department faculty, students will receive an academic overview of their graduation requirements and important policies and procedures. The goal is to get students started off strong with a schedule that will help them achieve their goals at New Paltz.

Open Houses – Various Locations

Explore the many support programs and communities available at SUNY New Paltz during our Open Houses.

**11:20 a.m. to
11:45 a.m.**

Building Your Nest – Lecture Center 100 (On-Campus Living) and Lecture Center 104 (Commuters)

Whether you're living on campus or commuting, this session will help you make the most of your SUNY New Paltz experience! Residential students will also complete their housing survey and start shaping their home away from home.

**11:50 a.m. to
12:15 p.m.**

Connect & Engage – Lecture Center 100

SUNY New Paltz offers countless ways to get involved beyond the classroom, helping you build valuable experiences and career-ready skills. In this session, you'll learn more about the New Paltz Student Association and the Residence Hall Student Association, as well as other campus involvement opportunities. You'll also receive tips for making the most of your Hawks experience!

**12:15 p.m. to
12:30 p.m.**

Next Steps at SUNY New Paltz – Various Locations

This is the final small group session with your Orientation Leader to celebrate the completion of your Orientation experience. Ask those last-minute questions and receive your Orientation t-shirt to wear at Convocation!

**12:45 p.m. to
3:30 p.m.**

Academic Overview & Registration

Students will register for their fall 2025 semester courses - their first official schedule at SUNY New Paltz! With the assistance of professional advisors from the Office of Academic Advising and department faculty, students will receive an academic overview of their graduation requirements and important policies and procedures. The goal is to get students started off strong with a schedule that will help them achieve their goals at New Paltz..

Open Houses – Various Locations

Explore the many support programs and communities available at SUNY New Paltz during our Open Houses.

**1:30 p.m. to
4:00 p.m.**

Check-Out – Bouton Hall

Please make sure to return your room and suite keys to the Administrative Program Assistants by 4:00pm to avoid being charged for missing keys. Hold onto your student ID card as you will need this when you come back in the Fall!

Day One Schedule



For both students and families



**8:30 a.m. to
10:00 a.m.**

Check-In & Campus Resource Fair

After you have dropped your student at Bouton Hall, head over to Ridgeview to check-in for the Family Program. Here, you will receive the keycard to your room and a special token of our appreciation. You will be escorted to the Lecture Center for the Campus Resource Fair where you will meet campus partners excited to tell you about themselves and involvement opportunities!!



**10:15 a.m. to
11:00 a.m.**

Welcome to SUNY New Paltz – Studley Theatre

This is your official welcome to SUNY New Paltz and kickoff to your Orientation experience! You will be greeted by President Wheeler and officially meet the Orientation Team, including your Orientation Leader!

**11:05 a.m. to
11:35 a.m.**

Lunch – Peregrine Dining Hall

We understand you may have missed breakfast this morning so let's break bread with each other. Use the meal ticket you received at check-in at the dining hall.

**11:40 a.m. to
12:00 p.m.**

On-Campus Living – Bouton Hall

Meet with staff from Residence Life to view a sample room for first-year students. You will also be able to ask the Residence Life staff questions.

**12:10 p.m. to
1:10 p.m.**

Student Accounts– CSB Auditorium

Find the necessary information about viewing students accounts, paying bills, financial aid, and more.

**1:15 p.m. to
1:55 p.m.**

Academic Success– CSB Auditorium

The Office of Academic Advising will be able to provide you with the basics of academics, course registration, the role of academic advisors, and more at SUNY New Paltz.



**2:00 p.m. to
2:20 p.m. and
2:30 to 2:50 p.m.**

Student Experience Breakout Sessions – Various Locations

Students and their families can explore key campus resources and discover how they contribute to a rewarding SUNY New Paltz experience. During two designated time blocks, you'll have the flexibility to select sessions that interest you most. [Details and locations for each session are listed on page 10.](#)

**3:00 p.m. to
4:00 p.m.**

Helping Your Student Transition – Lecture Center 102

The Psychological Counseling Center will discuss the opportunities and challenges your student may face during their first year at SUNY New Paltz. They will give you ways in which you can support their transition. You will also learn about services offered by the PCC and other campus resources, including how to access and refer students to these support systems.

**4:10 p.m. to
5:00 p.m.**

Dinner – College Terrace

Enjoy a special meal in the Student Union Building with other family members, Orientation staff, and professionals of Student Affairs.

**5:00 p.m. to
5:45 p.m.**

Families Connect – College Terrace

Dessert on us! After dinner, please enjoy sweet treats and ice cream to end the first day of your Orientation!



Explore and Unwind

The day doesn't have to end after dessert—take some time to explore the area your student will call home! Whether it's dining in the Village of New Paltz or shopping at the Poughkeepsie Galleria, there's plenty to see and do nearby. Scan the QR code to the left for suggestions of things to do in the Hudson Valley area!

Day Two Schedule



For both students and families

**7:30 a.m. to
9:00 a.m.**

Breakfast – Peregrine Dining Hall

Feel free to sleep in or head over to the dining hall with your Family Orientation Leader. Please use the breakfast meal ticket you received during check-in.

**9:15 a.m. to
11:15 a.m.**

The Orientation Players Presents: Realities – Studley Theatre

Realities is a dynamic, 12-skit production performed by Orientation Leaders that explores key challenges students may face in college. Through engaging and thought-provoking scenes, this session addresses topics like transitioning from high school, social media pitfalls, unhealthy vs healthy relationships, embracing diversity, and more.

**11:20 a.m. to
11:45 a.m.**

Connect & Engage – CSB Auditorium

SUNY New Paltz offers countless ways to get involved beyond the classroom, helping your student build valuable experiences and career-ready skills. In this session, you'll learn more about the New Paltz Student Association and the Residence Hall Student Association, as well as other campus involvement opportunities. You'll also receive tips to help your students make the most of their Hawks experience!

**11:50 a.m. to
12:15 p.m.**

Next Steps at SUNY New Paltz – CSB Auditorium

Join the Orientation Team as we celebrate the completion of your Orientation experience. We will be here to answer any last-minute questions and provide reminders of important dates.

**12:15 p.m. to
3:30 p.m.**

Campus Exploration – Various Locations

Take this time to stop by the Campus Bookstore and stock up on SUNY New Paltz swag! You can also take this time to explore the scenes of the campus while you wait for your student.

**12:15 p.m. to
3:30 p.m.**

Open Houses – Various Locations

Explore the many support programs and communities available at SUNY New Paltz during our Open Houses.

**1:30 p.m. to
4:00 p.m.**

Check-Out

Please make sure to return your room card to the Administrative Program Assistants by 4:00pm.



Peregrine Dining Hall



Studley Theatre Entrance



Cokoyndall Science Building



Ridgeview Hall



Bouton Hall



Lecture Center

Breakout Sessions

Select a session that aligns with your interests and what you feel will best support your transition into the semester. Students and their guests (if applicable) are encouraged to attend different sessions to maximize the information they receive.

Advancing Completion through Engagement Humanities 115

ACE (Advancing Completion through Engagement) is a comprehensive academic support program that provides Pell-eligible students with a dedicated ACE advisor to support their academic journey from start to finish. During this information session you will be provided with additional information about ACE and how to join.

Athlete's Meeting Lecture Center 113

Athletics, Wellness, and Recreation will introduce their department, covering the balance between academics and athletics, practice schedules, and basic expectations for student-athletes. This session will provide valuable insights into campus athletic life, with a brief Q&A to address any questions from students and families.

Career Resource Center Lecture Center 108

The Career Resource Center will provide a brief overview of the services that it offers to students. Following that, students will participate in an interactive game to learn about the different majors at SUNY New Paltz, how those connect to different career paths, and what they can do during their first year to get ahead of the career development curve!

Disability Resource Center Lecture Center 109

The Disability Resource Center will provide an overview of its services, support programs, and the steps for applying for accommodations at SUNY New Paltz.

Fraternity & Sorority Life Lecture Center 102

Fraternity and Sorority Life at SUNY New Paltz offers students a chance to build lifelong friendships, develop leadership skills, and give back through philanthropic efforts. We'll discuss the differences between active, inactive, and non-affiliated organizations, the requirements for joining, and how being part of the Fraternity and Sorority Life community can enhance personal growth, academic success, and community engagement.

Honors Program Humanities 113

The Honors Program is open to students from all majors. This session will provide an overview of opportunities offered through the program, information about requirements for admission, and an explanation of the application process.

Living Learning Communities/Riveria House CSB Auditorium

Explore the Living Learning Communities (LLCs) at SUNY New Paltz and discover how they can enhance your college experience by connecting you with peers who share similar interests or academic goals. This session will provide an overview of LLC themes, specialized programming, and the benefits of living in a close-knit, supportive community.

Safety at SUNY New Paltz (UPD & Ellie) Lecture Center 103

Get to know the SUNY New Paltz University Police Department and learn essential safety tips and resources to stay secure on campus. Meet our dedicated officers, discover campus safety initiatives, and connect with UPD's favorite furry friend during this informative session.

Scholar's Mentorship Program Humanities 111

The Scholar's Mentorship Program transforms students from protégé's to scholars through the completion of academic and social experiences. Come learn more about that process and how to join the program at the designated information session.

Student Leadership & Engagement Lecture Center 100

The Center for Student Engagement provides students with countless opportunities to get involved, build leadership skills, and make lasting connections. Whether through student organizations, community service, leadership programs, or campus events, getting involved enhances the college experience and helps students find their passion while making a difference on campus.

Study Abroad Lecture Center 104

Come learn about opportunities to study abroad during your time at New Paltz. Students in all programs and majors can receive credit toward their degree while studying abroad during the summer or a semester. We will cover opportunities available, financial aid and scholarships, and how to start planning.

Veterans, Service Members, and Dependent Students Humanities 116

Join the Office of Veteran & Military Services to learn how we support military-connected students; veterans, service members, and dependents (regardless of age or financial dependency). Discover the exclusive benefits, resources, and community waiting for you by affiliating with our office and meet the team that's here to guide you through your journey at New Paltz.

Open Houses



Honors Center

Honors Center, CH 111

For those students who are eligible to participate in the Honors Program, this is an opportunity to tour the center and learn about its services.



Scholars' Mentorship Program

SUB 035

For those students who are eligible to participate in SMP, this is an opportunity to tour the center and learn about its services.

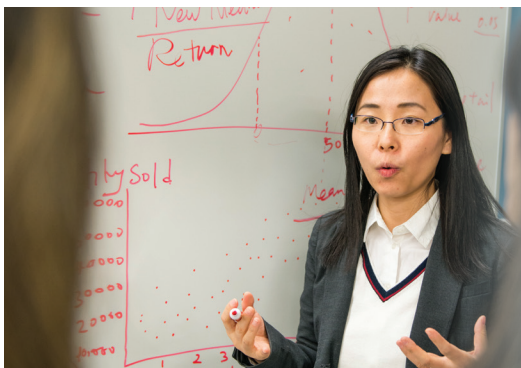

Advancing Completion Through Engagement (ACE)

SUB 62/63

SUNY New Paltz's ACE program is a comprehensive academic support initiative designed to assist students in completing their bachelor's degrees within two years for transfers or four years for freshmen. Modeled after CUNY's successful Accelerated Study in Associate Programs (ASAP), ACE offers intensive academic advisement, career counseling, and financial assistance for tuition, textbooks, and transportation.



Disability Resource Center

HAB 205

If your student had a 504 plan or an IEP in high school, the DRC is the place to be! Students with learning, psychological, and physical disabilities are encouraged to drop into the DRC's Open House. Staff will be available to meet with students and their families to discuss support services and accommodations (ie: extended time for exams) for the fall semester. Disability documentations can also be dropped off at this time.



Veterans, Service Members, and Dependent Students

SUB 100 South

This time with the OVMS serves two purposes. For students who need to, they can complete any outstanding GI Bill®, Military Tuition Assistance, and/or New York State (Tuition Assistance/ Grants / Scholarships) requirements. All who participate will have the opportunity to meet fellow students, see where the office is located, discuss transition to college supports such as the Mentoring Program and learn what services are offered through the office, such as: free parking & ID Cards (veterans & servicemembers), scholarships, pre-enrollment deposit waivers/refunds, and much more. GI Bill® is a registered trademark of the U.S. Department of Veterans Affairs (VA). More information about education benefits offered by VA is available at the official U.S. government Web site at www.benefits.va.gov/gibill.

Important Fall Semester Dates



Move-In
August 21



Family Weekend
October 4–5



Thanksgiving Break
November 26–28



Common Exam Day
December 11



**Best Week Ever-
Welcome Week**
August 21–27



**Fall Break
(No Classes)**
October 13–14



Last Day of Classes
December 8



**Fall Semester
Final Exams**
December 12–18



First Day of Classes
August 25



**Make A
Difference Day**
October 18



**Late Night
Breakfast**
December 8



**New Student
Convocation**
August 27



**Black Solidarity
Day**
November 3



Study Day
December 9–10

Important Campus Contacts

Athletics, Wellness & Recreation:

nphawks.com | athletics@newpaltz.edu
845-257-3910

Campus Auxiliary Services - ID Cards

newpaltzcas.com | 845-257-3034

Campus Auxiliary Services - Meal Plans

newpaltzdining.sodexomyway.com
845-257-3370

Career Resource Center

newpaltz.edu/careers
careers@newpaltz.edu | 845-257-3265

Center for Student Engagement

newpaltz.edu/studentengagement
cse@newpaltz.edu | 845-257-3025

Center for Student Success

newpaltz.edu/studentsuccess
css@newpaltz.edu | 845-257-3580

Disability Resource Center

www.newpaltz.edu/drc
drc@newpaltz.edu | 845-257-3020

Heritage Financial Credit Union

heritagefcu.com/branch/suny-campus
845-561-5607

Mail Services

newpaltz.edu/ocm/mail.html
MailServices@newpaltz.edu
845-257-3122

New Paltz Student Association

newpaltz.edu/studentaffairs/departments/
student-association
SA-President@newpaltz.edu
845-257-3070

Office of Academic Advising

newpaltz.edu/advising
advising@newpaltz.edu | 845-257-3015

Office of Veteran & Military Services

newpaltz.edu/veterans
ovms@newpaltz.edu | 845-257-6867

Parking

newpaltz.edu/parking
parking@newpaltz.edu | 845-257-3347

Psychological Counseling Center

newpaltz.edu/counseling
845-257-2920

Psychological Counseling Center: HAVEN

newpaltz.edu/counseling/oasishaven.html
845-257-4930

Psychological Counseling Center: OASIS

newpaltz.edu/counseling/oasishaven.html
845-257-4945

Residence Life

newpaltz.edu/reslife | reslife@newpaltz.edu
845-257-4444

Student Accounts

newpaltz.edu/student_accounts
stuacct@newpaltz.edu | 845-257-3150

Student Affairs

newpaltz.edu/studentaffairs
studentaffairs@newpaltz.edu
845-257-3260

Student Conduct & Community Standards

newpaltz.edu/student-conduct
conduct@newpaltz.edu | 845-257-3260

Student Financial Services

newpaltz.edu/financialaid
fao@newpaltz.edu | 845-257-3250

Student Health Services

newpaltz.edu/healthcenter
healthservice@newpaltz.edu
845-257-3400

Undergraduate Admission

newpaltz.edu/admissions/contact.html
admissions@newpaltz.edu
845-257-3200

University Bookstore

bkstr.com/sunynewpaltzstore
1651mgr@follett.com | 845-257-3050

University Police

newpaltz.edu/police
upd@newpaltz.edu | 845-257-2222

Welcome Week Signature Events



Welcome BBQ:

Kick off the semester with good food, music, and new connections at our Welcome BBQ! Reconnect with your Summer Orientation Leaders and meet fellow students who shared the same OL experience.



Best Week Ever Kick-Off: ACW Trivia

Think you know music? Put your knowledge to the test with ACW Trivia, a high-energy, interactive competition where every question connects to an artist, song, or dance. Compete for cash prizes and bragging rights in this fast-paced trivia showdown—just make sure your phone is charged and your music game is strong!



Planetarium Mini Shows:

Experience the bite-sized versions of our popular "Astronomy Nights" show, which occurs throughout the academic year. These 15-minute shows offer a captivating glimpse into the wonders of the universe.



Glow Party:

Reconnect with friends or make new connections at this exciting event hosted by the Residence Hall Student Association. This Glow Party is packed with dance music, glow items, giveaways, and so much more!



Humans vs. Zombies:

Humans vs Zombies is a modified game of team-based tag featuring Nerf blasters. This special Welcome Week mini game session will give new students a chance to have fun while meeting new friends. The club runs games like this weekly once the semester gets going, so come give it a try!



Movie Under the Stars:

Come join the Center for Student Engagement on Old Main Quad - a popular location for campus events - to watch a box off hit movie for free! Bring your blankets and snacks although some refreshments and snacks may be provided.



Shopping Trip @ Poughkeepsie Galleria:

Need to pick up some items you forgot to bring or buy? Just want to explore the closest mall to campus? Take a trip with the Center for Student Engagement to the Poughkeepsie Galleria. Seating is on a first-come, first-served basis.

Buses will return to campus at 5:30pm. If you require accessible transportation, please contact cse@newpaltz.edu prior to the event.



Summer Sundown:

Watch the sunset and say goodbye to summer break together with your classmates. Live music, refreshments with games & giveaways. Bring your own blanket!



A Night of Comedy:

Laughter is medicine for the soul! Join the Center for Student Engagement for an evening filled with fun, side aching laughs, and punchlines from an up-and-coming comedian!



Involvement Expo:

Come to this annual celebration that showcases local business and 220+ student clubs/organizations! Connect through fun, interactive activities at each table that will spark your interest and help you find your place on campus.



New Student Convocation:

Convocation celebrates who you are at the moment you became a New Paltz Hawk! The milestone is something we look forward to celebrating with you. To show your New Paltz pride, be sure to wear the color New Paltz t-shirt you received at Orientation.



Hugo's Free for All:

What's better than free stuff? A whole bunch of free stuff! Join the Student Engagement Board and the Center for Student Engagement for a night of free giveaways and prizes!



Poster Sale:

Join the Center for Student Media for the semesterly poster sale! Thousands of designs, posters small and large will be available for purchase in the Student Union Atrium.

SUNY New Paltz Alma Mater

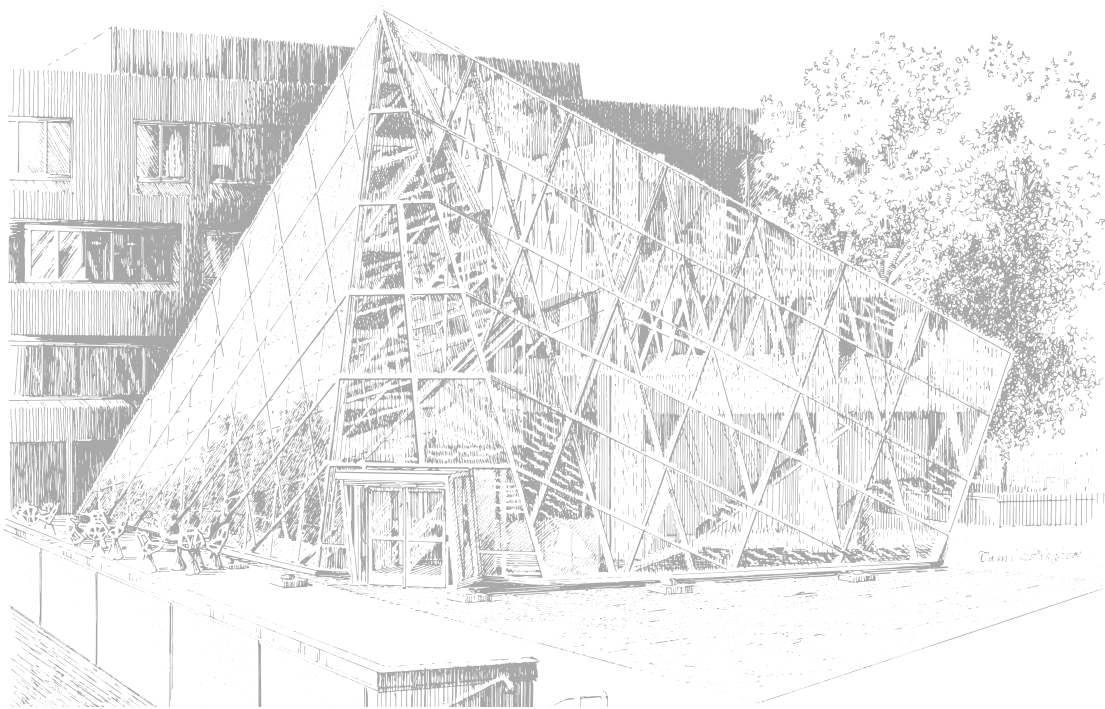

*In a valley fair and beautiful
Guarded well by mount and hill
Beats a heart whose pulse is rich and full
Of life, and pow'r, and thrill.
We love thee, Alma Mater dear.
To thee our hearts are true.
And we'll sing with voices strong and clear
To the Orange and Blue.
New Paltz, forever our Alma Mater,
We raise our song to thee.
The hills re-echo with glad crescendo
Our praises full and free.*

Orientation Experience

How was Your Orientation Experience?

Let us know by completing the Orientation Survey!



Students



Family

Become an Orientation Leader

Summer 2026 Orientation Leader Interest Form

Orientation Leaders (OLs) are a team of dedicated undergraduate students whose primary responsibility is to assist new students and their families with their transition into the SUNY New Paltz community and Hawks family. The Orientation Leader role will provide you with the opportunity to learn more about yourself and your personal values, challenge yourself, and most importantly aid new students in their transition to SUNY New Paltz.



Notes

This image shows a single sheet of white paper with horizontal ruling lines. The lines are evenly spaced and run across the width of the page. There are no margins, text, or other markings on the paper.

1.25 hours to
ALBANY
from New Paltz

2.5 hours to
BOSTON
from New Paltz

1.5 hours to
NEW YORK CITY
from New Paltz

1 hour to
BERGEN COUNTY
NEW JERSEY
from New Paltz

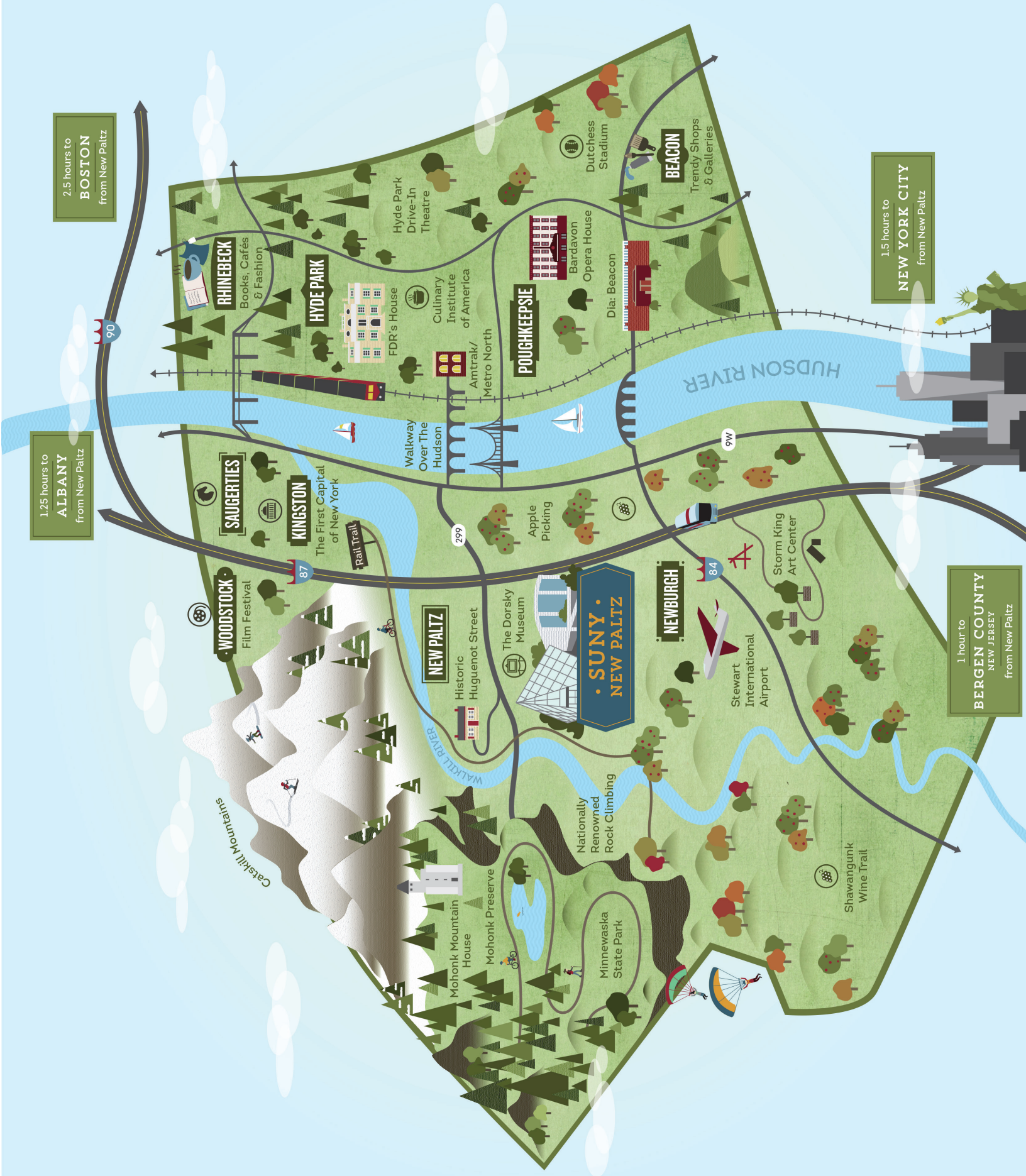

WOODSTOCK
Film Festival

KINGSTON
The First Capital
of New York

RHINEBECK
Books, Cafés
& Fashion

HYDE PARK

FDR's House
Culinary
Institute of America

POUGHKEEPSIE

Dutchess
Stadium
Bardavon
Opera House
Dia: Beacon

BEACON
Trendy Shops
& Galleries

NEW PALTZ

Historic
Huguenot Street

**SUNY
NEW PALTZ**

NEWBURGH

Stewart
International
Airport

Storm King
Art Center

Shawangunk
Wine Trail

Nationally
Renowned
Rock Climbing

Minnewaska
State Park

Mohonk Mountain
House
Mohonk Preserve

Catskill Mountains

HUDSON RIVER

WALKILL RIVER

